

DRAWING MADE IN THIRD ANGLE PROJECTION

THIS DRAWING IS UNPUBLISHED. RELEASED FOR PUBLICATION .19
 © COPYRIGHT 19 BY AMP INCORPORATED. ALL INTERNATIONAL RIGHTS RESERVED.

LOC	DIST	P	F	ZONE	LTR	REVISIONS	DATE	APPD
AF	50				C	REDRAWN PER 0051-93	3/5/93	JR/CM

1 SUPPLIED IN LOOSE PIECE

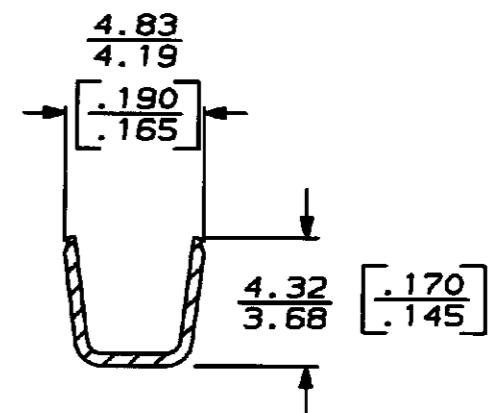
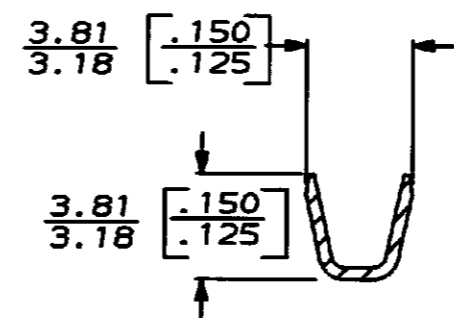
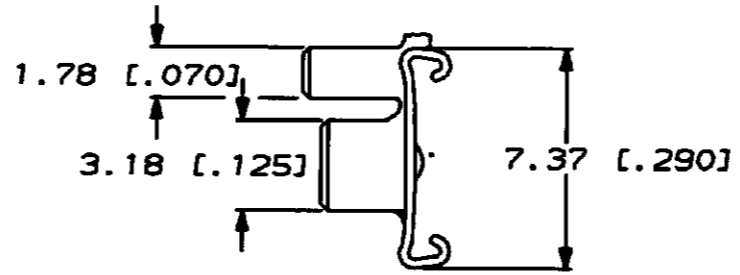
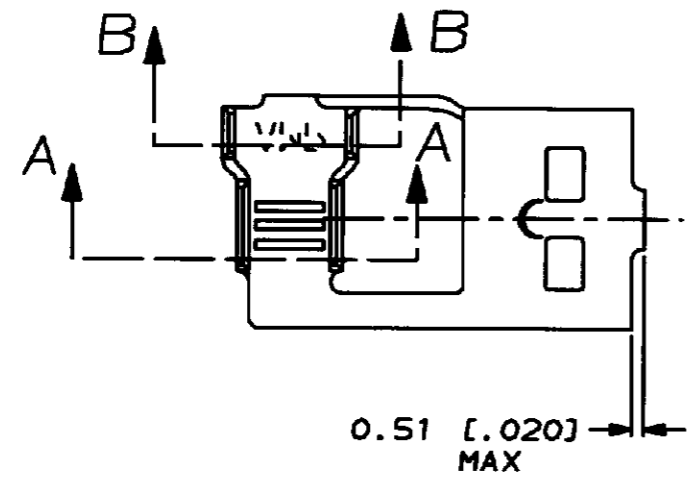

SECTION A-A

SECTION B-B

60290-2	2.29-3.56 DIA [.090-.140] DIA	0.8-2mm ² [18-14] AWG	0.81 [.032]	60419-2
STRIP FORM	INSUL RANGE	WIRE SIZE	MATING TAB THK ±0.025 [.001]	PART NO
DO NOT SCALE PRINT. UNLESS SPECIFIED DIMENSIONS IN mm (INCHES) TOLERANCES ON: 2 PLC DEC ± 0.25 (.010) 3 PLC DEC ± - ANGLES ± -		DR 3/5/93 JR RUTH CHK 3/5/93 JS PETER APPO 3/5/93 C REYERS APPO 3/5/93 R REINER PRODUCT SPEC -	AMP AMP Incorporated Harrisburg, PA 17105-3608	
MATERIAL 0.41 [.016] 4M BRASS		FINISH TIN .000080 MIN	NAME RECEPTACLE, FASTON, 6.35 [.250] SERIES	
THIS DRAWING IS A CONTROLLED DOCUMENT FOR AMP INCORPORATED. IT IS SUBJECT TO CHANGE AND THE CONTROLLING ENGINEERING ORGANIZATION SHOULD BE CONTACTED FOR THE LATEST REVISION.		APPLICATION SPEC -	SIZE B	CASE CODE 00779
		WEIGHT -	SCALE 4:1	DRAWING NO C-60419
				SHEET 1 OF 1

CUSTOMER DRAWING